

# The First Dream House

to Scale for 1:12 dollhouses  
Paper Minis, Prod. No. t1isoo6



## Required tools and supplies:

- X-acto knife and fresh blade
- A thin metal straightedge ruler. Make fold lines by pressing against edge of the ruler. A thin metal nail file works the best for the smaller items.
- Tweezers and detailing scissors
- Good cutting mat (cardboard will ruin your blades **and** project)
- Fast-grab, quick-dry white craft glue that dries clear
- Small piece of aluminum foil to use as a glue pot
- Slender artist's paint brush to apply glue. This will be used for most of the glueing.
- An acid-free glue stick



1. Cut out house exterior and fold as shown in this photo.

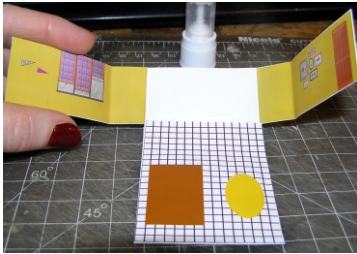

2. I used a glue stick to carefully glue the wallpaper and flooring. Make sure there is plenty of glue so that the two surfaces stay connected when folded.



3. Cut the back-wall box and glue the flat picture version to the inside of the back-wall box. Cut the two white areas and the tabs. Fold the tabs as shown in this photo.



©Copyright for Paper Minis projects held by Ann Vanture, 2010  
All rights reserved (worldwide rights)  
<http://www.paperminis.com>

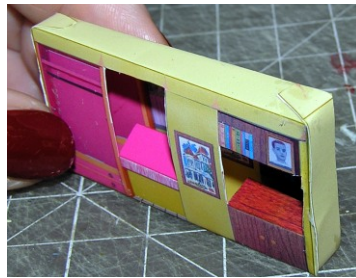

4. Make the box shape and glue tabs. Make sure the box stands straight. Note: I should have glued the small tabs to the inside for a better looking end result.



5. Pull the tabs forward and paint glue onto the two tabs. Carefully return the tabs to position against the back wall. Press bond. Note: I have discovered the benefits of using a dental pick for tasks like this one. A good dollar store will carry this item.



6. Make the vanity mirror stand and books box(s). Glue into place on the shelves. For an alternate display, put boyfriend photo in the bookcase and the smaller book set on the coffee table.



7. Glue the back-wall box to the inside of the house/suitcase.

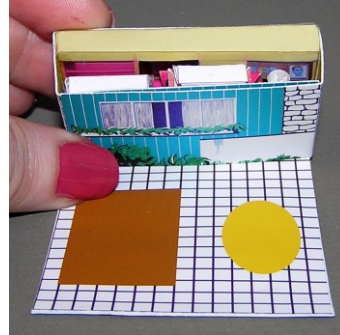

8. You will be able to fold the suitcase closed and fill with furniture for storage purposes, just like the actual human scale version.



## Stereo and Television Console

1. Make a box of the main unit.
2. Glue tabs to the blank inside surfaces.
3. Make the legs box. Make sure the end leg is glued correctly so both leg halves are displayed.
4. Fold legs vertically and glue into a square. Fold down tabs
5. Glue leg box to underside of console box.
6. Take stereo lid and fold the wood panels together and glue blank sides together.
7. Fold lid at white panel edge. Glue to back of console box to make a faux stereo lid.

## Danish Modern Lamp

1. Cut legs. Cut slit on dotted lines.
2. Slide two parts into each other to form a cross of legs.
3. Roll shade until it slides easily over legs (leave feet exposed). Glue side of shade when you have the correct size.

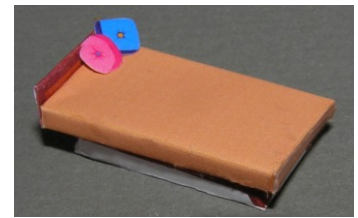

## Danish Modern Style Bed

1. Make a box of the mattress. Glue tabs to blank inside surface.
2. Construct the legs box. Ensure the end leg displays both halves.
3. Fold headboard in half and glue blank sides together.
4. Glue headboard to bed mattress.
5. Glue pillows of choice.



## Sofa and Easy Chair

1. Instructions are the same for each piece. Make a box of the seat cushion. Note: if the tabs are too bulky, you may carefully cut off the tiniest of the tabs.
2. Make an upright box of the back cushion.
3. Glue back cushion to seat cushion
4. Make the legs box and glue to the underside of the seat unit.
5. Glue pillows of your choice.

## Ottoman

1. Fold ottoman into the shape of a cube.
2. Glue side tab to inside blank surface.
3. Glue top and bottom to tabs.

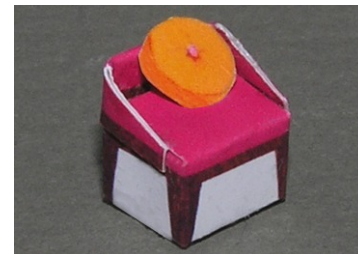

## Vanity Chair

1. Make chair cube.
2. Fold chair back along dotted line and trim carefully.
3. Form backing to chair cube. Glue into place.
4. Glue pillow cutout of your choice.



## Coffee Table

1. Use a thin metal nail file to fold back to tabletop tabs, and glue in place.
2. Make the table legs box, glue box to tabletop underside.

Visit the Paper Minis website on-line tutorial website. To view a PDF version of this tutorial. The PDF on-line gives you the capability to zoom in on the photos.